

# Permanent Local Housing Allocation Competitive Grants Program

The **Permanent Local Housing Allocation (PLHA)** competitive grants program provides funding to increase the supply of housing for households with incomes of 60 percent or less of Area Median Income (AMI). This investment helps facilitate housing affordability for people experiencing or at risk of homelessness.

ELIGIBLE APPLICANTS:  
Non-entitlement Jurisdictions

## ELIGIBLE USES:

- 1** Development of new multifamily rental housing or substantial rehabilitation of non-restricted multifamily rental housing that is affordable to households at or below 60 percent AMI.
- 2** Assistance to persons who are experiencing or at risk of homelessness through rapid rehousing; rental assistance; supportive and case management services; operating and capital costs for navigation centers; or new construction, rehabilitation, or preservation of permanent or transitional rental housing.

**Mercy Housing's 1180 Fourth Street**, a gateway to San Francisco's Mission Bay South neighborhood features affordable rental homes for very-low and low-income families and affordable apartments for formerly homeless households.

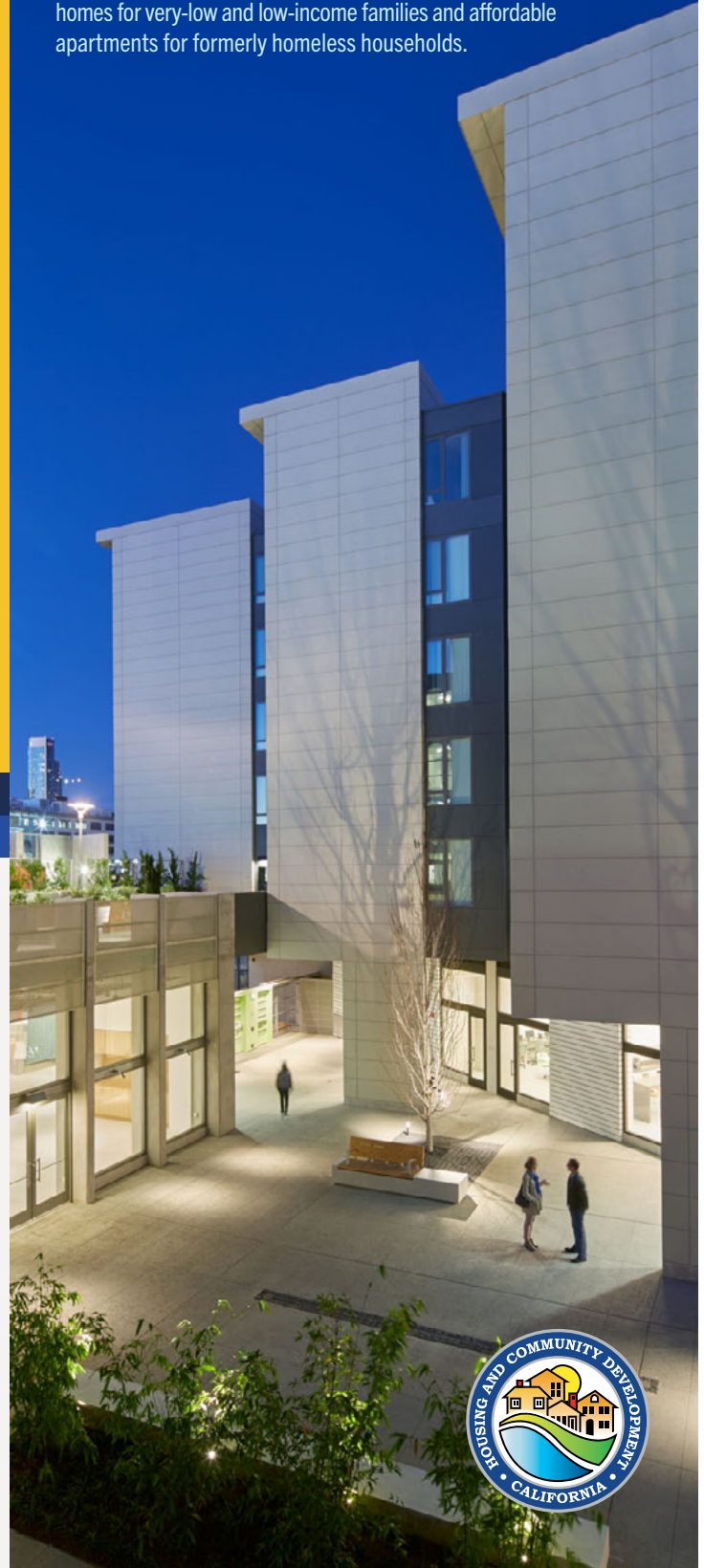

For more information, visit the **PLHA webpage**.

Find us online at: [hcd.ca.gov](http://hcd.ca.gov)

